

LASERMAX LX500



LX550 Unwinder

The Lasermax LX550 Unwinder feeds a roll of paper, up to 20.5" wide and 52" in diameter, into a printer or inserter at speeds up to 600 feet per minute. It is based on the print industry standard of a center-shaft drive mechanism making it the most accurate and reliable roll-feed system available. It uses a new CPU capable of remote diagnostics and enhanced error recovery. In addition, it uses the new UP3I interface standard for intelligent communication between all machines and the printer. The LX550 Unwinder has an attractive ergonomic design with an interactive, touch-screen display for greater ease of use. Its integrated splice station works with both pinfed and pinless paper.

Benefits of the Lasermax LX550 Unwinder

- Quick loading and changing of rolls
- Center-shaft driven – no surface contact with forms
- Compatible with pressure sensitive labels
- Ability to feed directly into inserters
- Attractive ergonomic design
- Low profile – unobstructed view of operation
- Easy to use splice station
- No exposed “pinch points” for maximum safety
- Positive locking feature for airshaft – no operator adjustments

Standard features of the Lasermax LX550 Unwinder

- Internal triple loop
- New CPU
- UP3I compliance
- Increased speed – up to 600 ft/min
- Interactive touch-screen display
- Automatic end of roll detector
- Compatible with multiple core sizes

LX550 Unwinder

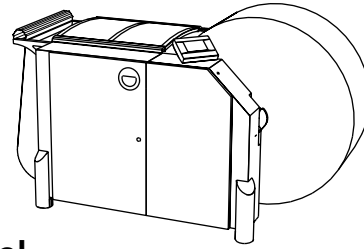

General

Web transport	Pinfeed or pinless	
Roll diameter	Max.	1320 mm 52"
	Min.	100 mm 4"
Web width	Max.	520 mm 20.5"
	Min.	155 mm 6"
Weight of roll	Max.	630 kg 1389 lb
	Paperweight 40 - 200 gsm	
Web speed	Max.	3.0 m/s 600 feet/min
	Min.	0.5 m/s 100 feet/min
Approvals	CE (89/392/EEC), EMC Class A, LVD, CB EN 60950, cULus 1950 3rd, FCC15 Class A, VCCI	
Color	Grey	

Electrical

North America	15A, 1 Phase, 208 V, REC=L6-15R
Other Countries	10A, 200-208 (+6% -10%) VAC 1-60Hz
	10A, 230-240 (+6% -10%) VAC 1-50Hz
Power consumption	Standby 120 W Running 500 W
Heat emission	300 kcal/h, 1200 kJ/h, 1150 BTU

Environment

Operating noise	65 dB(A)
Rel. humidity	50 ±10%

Physical

Length, incl loop	1825 mm	72"
Length, incl loop and max paper roll	2310 mm	91"
Width	1050 mm	41.4"
Height, excl. display	1155 mm	45.25"
Weight	720 kg	1587 lb

Service area

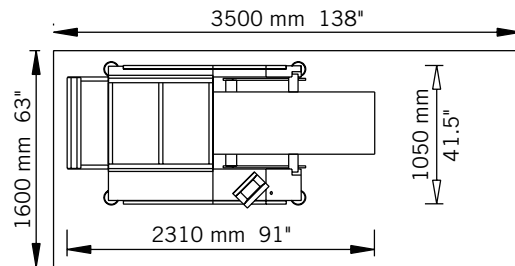

Options

Airshafts	70 mm, 3", 150 mm, 200 mm, 5" and 6"
Splice sensor	To detect splice in paper roll
Interface	To all printers
Fan	To control paper loop
Wheels	To move the unwinder
Low speed kit	To feed low speed printers (0.1- 0.5 m/s) (20 - 100 feet/min)
Trolley	For paper rolls

World Headquarters

Strålfors AB
Business Area Lasermax
Långgatan 21
S-341 84 LJUNGBY
Sweden
Phone +46 372 850 00
Fax +46 372 828 37
lasermaxinfo@stralfors.se

Belgium

Stralfors nv
Phone +32 3 780 70 70
info.lasermax@stralfors.be

Denmark

Stralfors A/S
Phone +45 43 434 300
info@stralfors.dk

Great Britain

Stralfors Plc
Phone +44 1793 488 008
lasermaxinfo@stralfors.co.uk

North & South America

Stralfors Inc.
Phone +1 630 271 3900
information@stralfors-us.com